

45° ANGLED BARS INSTALLED  
AT EACH CORNER

2'-0"

HORIZONTAL BARS TO EXTEND  
A MINIMUM OF 24" BEYOND OPENING

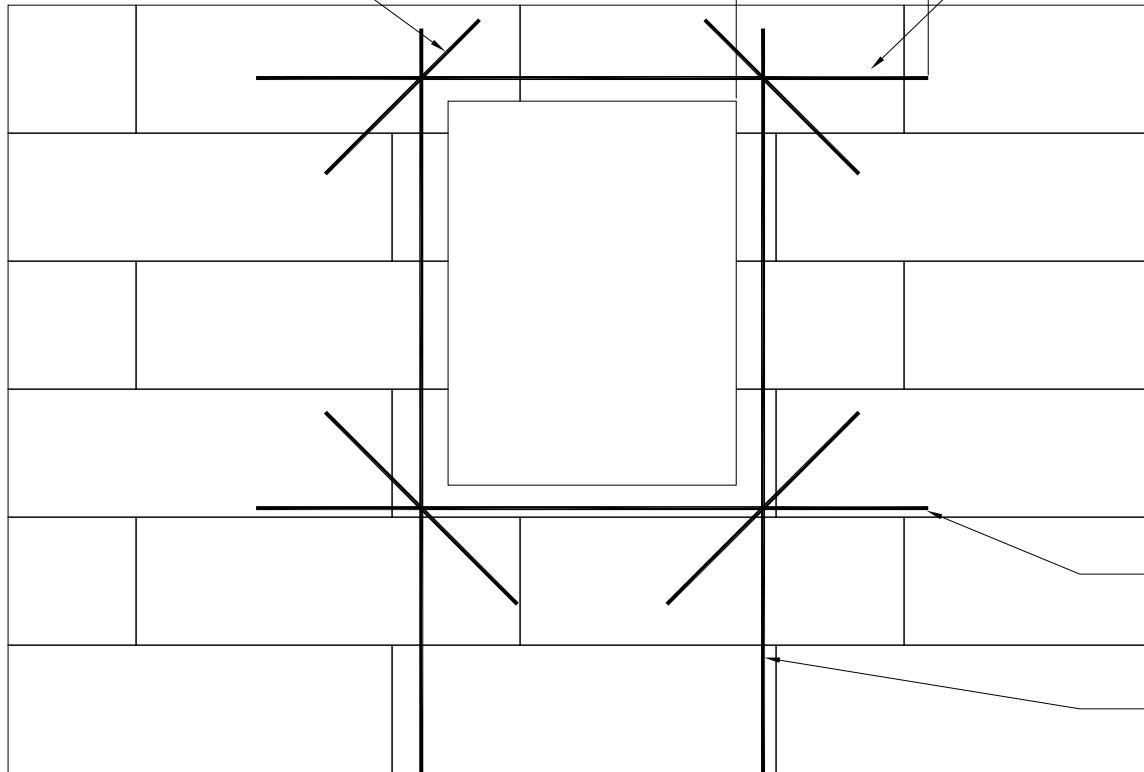

NOTE:  
LINTEL REINFORCEMENT WILL  
VARY DEPENDING ON OPENING  
SIZE. REFERENCE STRUCTURAL  
DETAILS FOR SPECIFIC  
REINFORCING REQUIREMENTS.

HORIZONTAL BARS TO EXTEND  
A MINIMUM OF 24" BEYOND OPENING

ADDITIONAL VERTICAL STEEL  
INSTALLED EACH SIDE OF OPENING



1200 Industrial St., Reedsburg, WI 53959  
Phone: (608) 524-5813 ■ Fax: (608) 524-2362  
www.CELBLOX.com

### CELBOX TYPICAL LINTEL REINFORCING

DATE: 2016

SCALE: 1" = 1'-0"

REVISION:

DRAWING NUMBER: